



PRODUCT DATA SHEET

MX25S-2SF - 1" DIGITAL FLOW METER WITH ER DISPLAY

The MX Series 1" DIGITAL FLOW METER are suitable for flows between 6 – 120 L/min (1.59 - 31.70 GPM), providing highly accurate flow measurement performance. The MX Series offers $\pm 0.5\%$ accuracy of true reading in a compact footprint, requiring no flow conditioning and with high pressure and temperature capabilities.

Key features include:

- Aluminium (6061) construction
- FEP Encapsulated seals
- Maximum flow rate 120 L/min / 31.70 GPM
- Accuracy of $\pm 0.5\%$ of reading
- Exceptional repeatability of $\pm 0.03\%$
- Temperature up to 120 °C / 248 °F
- 1 point factory calibration as standard, with additional points upon request

SPECIFICATIONS



ER Digital Register

MX25S-2SF

| | | MX25S-2SF | | |
|---------------------------------|--------|-----------------------|-------|-------|
| Material of construction | | | | |
| Meter Body | | Aluminium (6061) | | |
| Rotor | | Stainless Steel (316) | | |
| Seals | | FEP Encapsulated | | |
| Design Specifications | | | | |
| Process Connections | | 1" NPT Thread | | |
| Technical Specifications | | min | max | |
| Flow rate | < 5cPr | 10 | 100 | L/min |
| | | 2.64 | 26.42 | GPM |
| > 5cP | | 6 | 120 | L/min |
| | | 1.59 | 31.70 | GPM |
| Non lubricating fluids | | - | 120 | L/min |
| | | - | 31.70 | GPM |
| Operating Temperature Range** | | -40 | 120 | °C |
| | | -40 | 248 | °F |
| Accuracy ($\pm\%$) | | $\pm 0.5\%$ | | |
| Repeatability ($\pm\%$) | | $\pm 0.03\%$ | | |
| Nominal K-Factor | | 36 Pulses/Litre | | |
| | | 136.31 Pulses/Gallon | | |

OUTPUT TYPE



ER DISPLAY

| | | ER [LCD 17mm display] |
|--------------------------|--|---|
| Construction | | Aluminium |
| IP Rating | | IP67 |
| Temp | | Min: -40 Max: 80 °C Min: -40 Max: 176 °F |
| EX Approvals | | - Please refer to instruction manual and certification documentation for product appropriate certification information |
| Display | | 17mm/8mm |
| Digit size (upper/lower) | | ✓ |
| Accumulated total | | ✓ |
| Resettable total | | ✓ |
| Preset total | | ✗ |
| Flow rate | | ✓ |
| Outputs | | |
| 4-20 mA (passive) | | ✗ |
| Pulse/Transistor Output | | ✗ |
| Flow Alarm | | ✗ |
| Batch Control output | | ✗ |



PRODUCT DATA SHEET

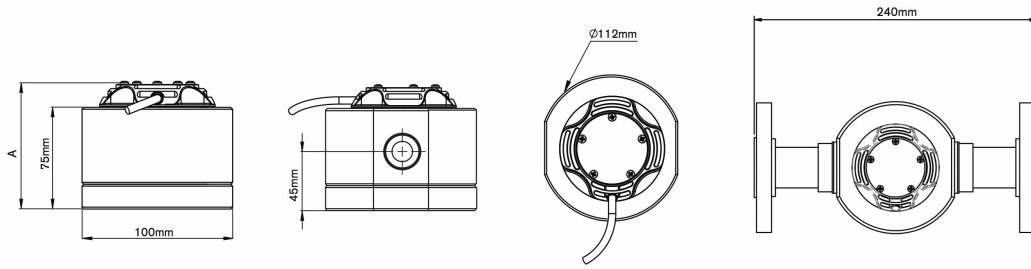

PULSER AND DISPLAY HEIGHT - A

OUTPUT A,I,J,K
PULSER - Standard

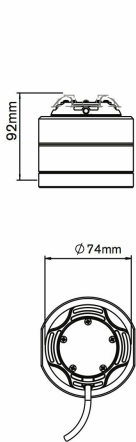

OUTPUT B
PULSER - Exia

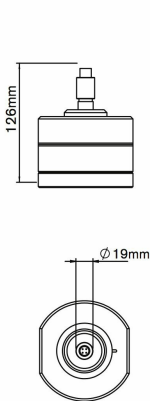

OUTPUT C
PULSER - EXd

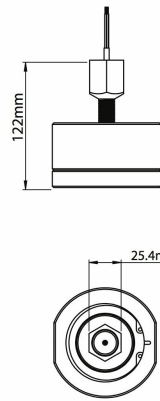

OUTPUT N
PULSER - Exia

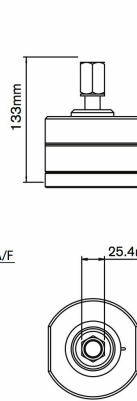

OUTPUT T
PULSER - High Temp.

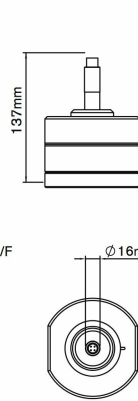

OUTPUT D,E
DISPLAY - LCD 12mm

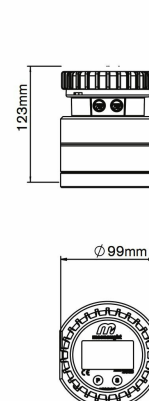

OUTPUT F,G,H DISPLAY
- LCD 17mm

